

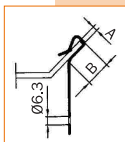

Elementos de fijación rápida
Elements de fixation rapide

Quick attachment devices
Schnellen befestigungselemente

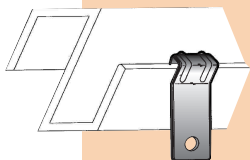

A mm.	B mm.	Kg.		Negro / Noire / Black / Schwarze		€/100
				Cód.	Ref.	
1,5 - 5	20	45	100	10013170	PHZ (120)	21,90

Acabado / Finition / Finishing / Endverarbeitung: SINARD						
1,5 - 5	20	45	100	1001317050	PHZ DT (120 DT)	28,60

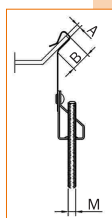
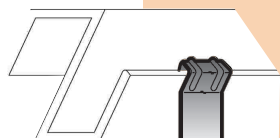

A mm.	B mm.	M	Kg.		Negro / Noire / Black / Schwarze		€/100
				Cód.	Ref.		
1,5 - 5	20	M6	45	100	10013850	PHZ-ICA6 (120-210)	87,80
1,5 - 5	20	M8	45	100	10013851	PHZ-ICA8 (120-211)	87,80
1,5 - 5	20	M10	45	100	10013852	PHZ-ICA10 (120-212)	87,80

Acabado / Finition / Finishing / Endverarbeitung: SINARD							
1,5 - 5	20	M6	45	100	1001385050	PHZ-ICA6 DT (120-210 DT)	115,10
1,5 - 5	20	M8	45	100	1001385150	PHZ-ICA8 DT (120-211 DT)	115,10
1,5 - 5	20	M10	45	100	1001385250	PHZ-ICA10 DT (120-212 DT)	115,10

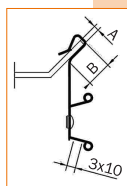
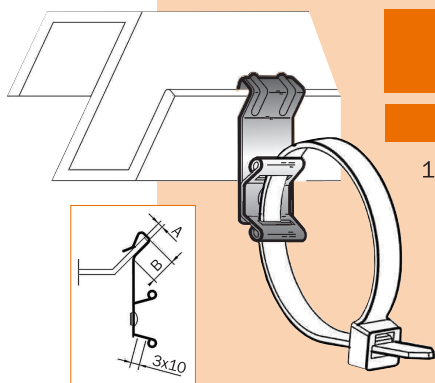

A mm.	B mm.	Kg.		Cód.	Ref.	€/100
1,5 - 5	20	15	100	1001317950	PHZ-BR DT (120-250 DT)	56,00

Acabado / Finition / Finishing / Endverarbeitung: SINARD						
---	--	--	--	--	--	--

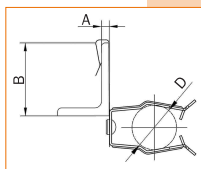
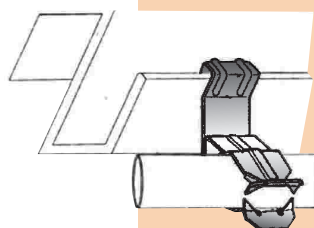

A mm.	B mm.	∅D mm.	Kg.		Cód.	Ref.	€/100
1,5-5	20	18-22	7	100	1001357650	PHZ-IC22DT (120-280 DT)	76,10
1,5-5	20	22-30	7	100	1001357750	PHZ-IC30DT (120-281 DT)	80,50
1,5-5	20	30-35	7	100	1001357850	PHZ-IC35DT (120-282 DT)	84,80

Acabado / Finition / Finishing / Endverarbeitung: SINARD						
---	--	--	--	--	--	--