

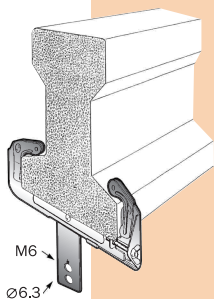

**SOPORTE PARA VIGAS DE HORMIGÓN - SUPPORT POUR POUTRE EN BETÓN
CONCRETE BEAM SUPPORT - STÜTZE FÜR BETONBALKEN**

MONTAJE - MONTAGE - INSTALLATION - MONTAGE:

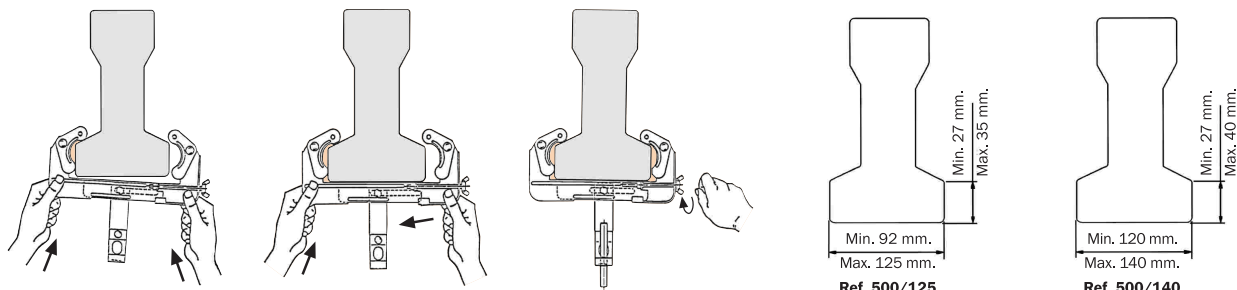

Kg.		Cód.	Ref.	€/100
90	50	10013267	500/125	406,60
90	50	10013282	500/140	406,60

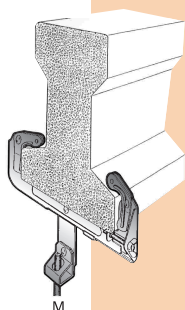

M	Kg.		Cód.	Ref.	€/100
M6	70	50	10013268	500-210/125	512,50
M6	70	50	10013283	500-210/140	512,50
M8	70	50	10013269	500-211/125	512,50
M8	70	50	10013284	500-211/140	512,50
M10	70	50	10013270	500-212/125	512,50
M10	70	50	10013285	500-212/140	512,50

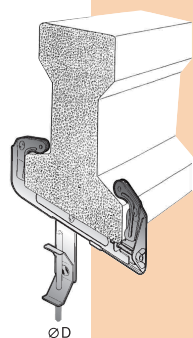

ØD mm.	Kg.		Cód.	Ref.	€/100
4	60	100	10013271	500-220/125	490,20
4	60	100	10013286	500-220/140	490,20
6	60	100	10013272	500-221/125	490,20
6	60	100	10013287	500-221/140	490,20

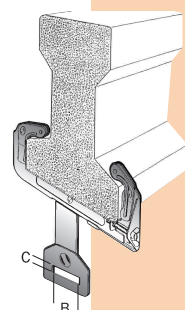

B x C	Kg.		Cód.	Ref.	€/100
28 x 6'5	45	50	10013273	500-230/125	479,00
28 x 6'5	45	50	10013288	500-230/140	479,00