



Elementos de fijación rápida
Elements de fixation rapide

Quick attachment devices
Schnellen befestigungselemente



A mm.	B mm.	Kg.		Negro / Noire / Black / Schwarze Cód.	Ref.	€/100
1,5 - 4	18	70	100	10013001	FH4 (100)	26,00
4 - 10	25	90	100	10013002	FH10 (101)	36,60
10 - 15	25	90	100	10013003	FH15 (102)	40,50
15 - 20	25	90	100	10013004	FH20 (103)	44,10

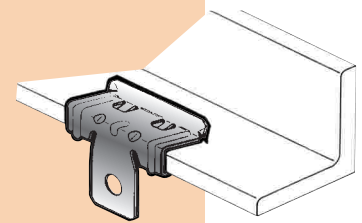

Acabado / Finition / Finishing / Endverarbeitung: SINARD						
1,5 - 4	18	70	100	1001300150	FH4 DT (100 DT)	33,80
4 - 10	25	90	100	1001300250	FH10 DT (101 DT)	47,50
10 - 15	25	90	100	1001300350	FH15 DT (102 DT)	52,70
15 - 20	25	90	100	1001300450	FH20 DT (103 DT)	57,40

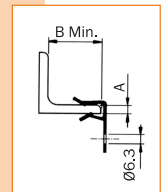

A mm.	B mm.	M	Kg.		Negro / Noire / Black / Schwarze Cód.	Ref.	€/100
4 - 10	18	M6	20	100	10013190	FH10 AP-R (101 AP-R)	62,20
10 - 15	25	M6	20	100	10013191	FH15 AP-R (102 AP-R)	67,40

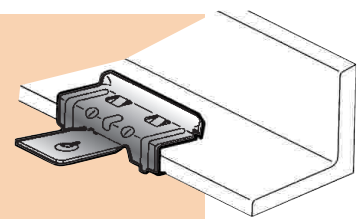

Acabado / Finition / Finishing / Endverarbeitung: SINARD							
4 - 10	18	M6	20	100	1001319050	FH10 AP-R DT (101 AP-R DT)	81,00
10 - 15	25	M6	20	100	1001319150	FH15 AP-R DT (102 AP-R DT)	87,70

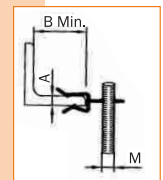

A mm.	B mm.	M	Kg.		Negro / Noire / Black / Schwarze Cód.	Ref.	€/100
4 - 10	18	M6x9	20	100	10013195	FH10 AP-T (101 AP-T)	83,40
10 - 15	25	M6x9	20	100	10013196	FH15 AP-T (102 AP-T)	92,10

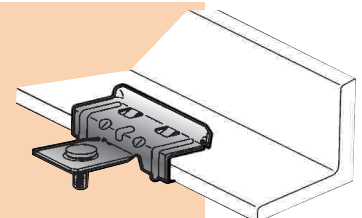

Acabado / Finition / Finishing / Endverarbeitung: SINARD							
4 - 10	18	M6x9	20	100	1001319550	FH10 AP-T DT (101 AP-T DT)	111,70
10 - 15	25	M6x9	20	100	1001319650	FH15 AP-T DT (102 AP-T DT)	119,80

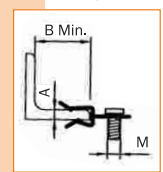

A mm.	B mm.	CxD	Kg.		Negro / Noire / Black / Schwarze Cód.	Ref.	€/100
1,5 - 4	18	28 x 6,5	45	100	10013054	FH4-SH (100-230)	39,60
4 - 10	25	28 x 6,5	45	100	10013069	FH10-SH (101-230)	56,00
10 - 15	25	28 x 6,5	45	100	10013084	FH15-SH (102-230)	62,60
15 - 20	25	28 x 6,5	45	100	10013099	FH20-SH (103-230)	69,90

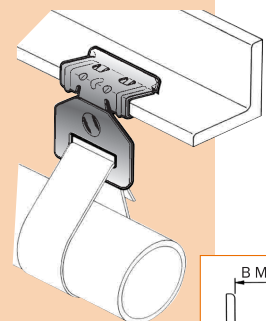

Acabado / Finition / Finishing / Endverarbeitung: SINARD							
1,5 - 4	18	28 x 6,5	45	100	1001305450	FH4-SH DT (100-230 DT)	51,50
4 - 10	25	28 x 6,5	45	100	1001306950	FH10-SH DT (101-230 DT)	72,70
10 - 15	25	28 x 6,5	45	100	1001308450	FH15-SH DT (102-230 DT)	81,70
15 - 20	25	28 x 6,5	45	100	1001309950	FH20-SH DT (103-230 DT)	91,30

