



Elementos de fijación rápida
Elements de fixation rapide

Quick attachment devices
Schnellen befestigungselemente



| A mm. | B mm. | Kg. | | Negro / Noire / Black / Schwarze | | |
|--|----------|-----|-----|----------------------------------|------------------|--------------|
| | | | | Cód. | Ref. | €/100 |
| 1,5 - 4 | 18 | 70 | 100 | 10013001 | FH4 (100) | 32,10 |
| 4 - 10 | 25 | 90 | 100 | 10013002 | FH10 (101) | 45,20 |
| 10 - 15 | 25 | 90 | 100 | 10013003 | FH15 (102) | 50,10 |
| 15 - 20 | 25 | 90 | 100 | 10013004 | FH20 (103) | 54,50 |
| Acabado / Finition / Finishing / Endverarbeitung: SINARD | | | | | | |
| 1,5 - 4 | 18 | 70 | 100 | 1001300150 | FH4 DT (100 DT) | 41,80 |
| 4 - 10 | 25 | 90 | 100 | 1001300250 | FH10 DT (101 DT) | 58,70 |
| 10 - 15 | 25 | 90 | 100 | 1001300350 | FH15 DT (102 DT) | 65,10 |
| 15 - 20 | 25 | 90 | 100 | 1001300450 | FH20 DT (103 DT) | 71,00 |

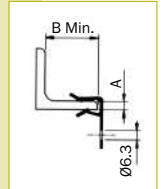
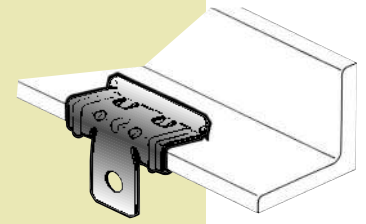

| A mm. | B mm. | M | Kg. | | Negro / Noire / Black / Schwarze | | |
|--|----------|----|-----|-----|----------------------------------|----------------------------|---------------|
| | | | | | Cód. | Ref. | €/100 |
| 4 - 10 | 18 | M6 | 20 | 100 | 10013190 | FH10 AP-R (101 AP-R) | 76,90 |
| 10 - 15 | 25 | M6 | 20 | 100 | 10013191 | FH15 AP-R (102 AP-R) | 83,40 |
| Acabado / Finition / Finishing / Endverarbeitung: SINARD | | | | | | | |
| 4 - 10 | 18 | M6 | 20 | 100 | 1001319050 | FH10 AP-R DT (101 AP-R DT) | 100,20 |
| 10 - 15 | 25 | M6 | 20 | 100 | 1001319150 | FH15 AP-R DT (102 AP-R DT) | 108,40 |

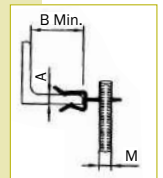
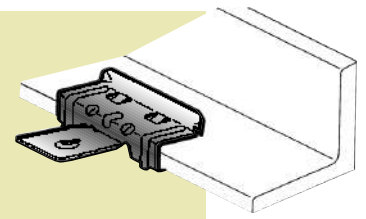

| A mm. | B mm. | M | Kg. | | Negro / Noire / Black / Schwarze | | |
|--|----------|------|-----|-----|----------------------------------|----------------------------|---------------|
| | | | | | Cód. | Ref. | €/100 |
| 4 - 10 | 18 | M6x9 | 20 | 100 | 10013195 | FH10 AP-T (101 AP-T) | 103,10 |
| 10 - 15 | 25 | M6x9 | 20 | 100 | 10013196 | FH15 AP-T (102 AP-T) | 113,90 |
| Acabado / Finition / Finishing / Endverarbeitung: SINARD | | | | | | | |
| 4 - 10 | 18 | M6x9 | 20 | 100 | 1001319550 | FH10 AP-T DT (101 AP-T DT) | 138,10 |
| 10 - 15 | 25 | M6x9 | 20 | 100 | 1001319650 | FH15 AP-T DT (102 AP-T DT) | 148,10 |

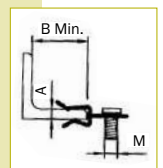
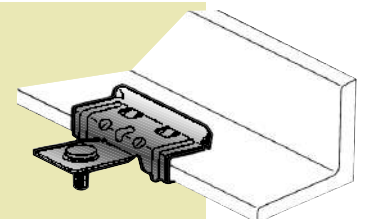

| A mm. | B mm. | CxD | Kg. | | Negro / Noire / Black / Schwarze | | |
|--|----------|----------|-----|-----|----------------------------------|-------------------------|---------------|
| | | | | | Cód. | Ref. | €/100 |
| 1,5 - 4 | 18 | 28 x 6,5 | 45 | 100 | 10013054 | FH4-SH (100-230) | 49,00 |
| 4 - 10 | 25 | 28 x 6,5 | 45 | 100 | 10013069 | FH10-SH (101-230) | 69,20 |
| 10 - 15 | 25 | 28 x 6,5 | 45 | 100 | 10013084 | FH15-SH (102-230) | 77,30 |
| 15 - 20 | 25 | 28 x 6,5 | 45 | 100 | 10013099 | FH20-SH (103-230) | 86,40 |
| Acabado / Finition / Finishing / Endverarbeitung: SINARD | | | | | | | |
| 1,5 - 4 | 18 | 28 x 6,5 | 45 | 100 | 1001305450 | FH4-SH DT (100-230 DT) | 63,70 |
| 4 - 10 | 25 | 28 x 6,5 | 45 | 100 | 1001306950 | FH10-SH DT (101-230 DT) | 89,80 |
| 10 - 15 | 25 | 28 x 6,5 | 45 | 100 | 1001308450 | FH15-SH DT (102-230 DT) | 101,00 |
| 15 - 20 | 25 | 28 x 6,5 | 45 | 100 | 1001309950 | FH20-SH DT (103-230 DT) | 112,90 |

